

Wake up to a  
NEW JOY EVERY DAY



Ashoka  
Springfields

a project from  
S.S Projects

awaken to  
a new freedom  
of choice



### About our project

We just don't want to build homes we want to create landmarks. Sai Shakti and SVAS Infraalong with their vast experience have collaborated together to achieve this endeavor. This led to the formation of SS Projects. Ashoka Springfields is first step in this mission. Apt location, quality construction, and beautiful design make this project stand out from the rest. Attention to detail can be found in every aspect right from design, materials used to amenities and planning. Be it dream home or a property investment Ashoka Springfields is your first choice.



**an iconic landmark**  
of thoughtful  
and graceful  
living spaces



clean-lined spaces  
for fresh and  
light palette



## TYPICAL FLOOR PLAN

### AREA STATEMENT

FLAT No	1	2	3	4	5	6	7	8
AREA IN SFT	1768	1268	1262	1261	1455	1262	1268	1768



The future belongs  
to those who believe  
in the beauty of their  
dreams



## SPECIFICATIONS

### STILT PARKING PLAN

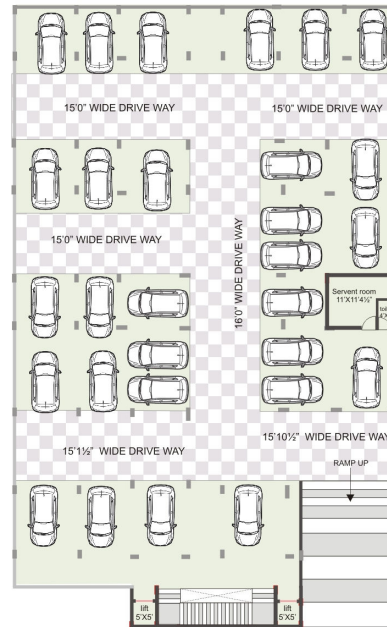
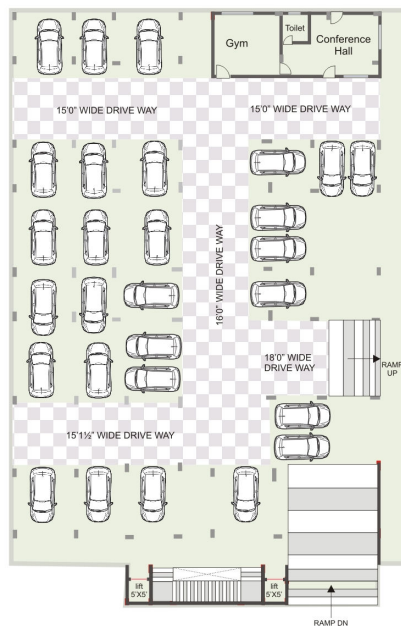

### CELLAR PARKING PLAN



- STRUCTURE**  
R.C.C. framed structure
- SUPERSTRUCTURE:**  
Outer walls are 9" thick & inner walls are 4 1/4" thick first class brick work with cement mortar (1:6 prop)
- FINISHING:**  
Plastering of ceiling and walls in C.M with smooth 'luppam' finishing
- MAIN DOORS:**  
Best teak wood frame with teak wood shutters (Polish quality) and standard hardware
- DOORS:**  
Medium teak wood frame with designer flush/OST panel shutters and standard hardware
- WINDOWS:**  
Aluminium powder coated window system with opaque glass and safety grills
- FLOORING:**  
Vitrified tiles in hall, dining, bedrooms and kitchen. Ceramic tile flooring in toilets and balconies
- KITCHEN**  
Black granite cooking platform with stainless steel sink and 2" height ceramic/glazed tiles dado
- TOILETS:**  
Glazed ceramic tile dado upto 60" height. Cascade EWC with health faucet for all bathroom of Hindware/ equivalent make. All C.P fittings are chrome plated of ESS ESS or equivalent make for all bathrooms.
- ELECTRICAL:**  
Concealed internal wiring with Finolex or equivalent make insulated copper wires for all points. Best quality modular type switches and sockets of Legrand or equivalent make. Adequate number of light/fan points in every room considering interior layouts. Adequate power points in kitchen for grinders/mixers/cooking range/exhaust chimney/microwave oven etc., and in utility area for washing machines /driers/dish washers etc. Separate metering for power in each house
- COMMUNICATION SYSTEMS:**  
Telephone points and TV points in living room and master bedroom and provision for DTH TV service. Telephone cabling with high speed Cat6 cables. Internal provision in master bedroom and children bedroom using Cat6 cables.



Interesting array of subtle elements to infuse a positive vibe



## AMENITIES

- Land Scaping
- Children Play Area
- Intercom: All flats are interconnected and connected to security room
- Full power backup for common amenities like lights in common areas, lifts and pump.
- Power backup for 3 lights and 3 fan Points in each flat.
- 2 level Car Parking
- Manjeera Water and Electricity
- Gym and lounge room



## PROMOTING COMPANY PROFILES



Saishakti has, over years earned a resounding reputation for building the finest homes in the choicest locations, with their dedication to quality and innovative concepts and futuristic vision with each of their ventures, they have been stretching the definition of comfort, convenience and luxury in urban dwellings.

[www.saishaktiinfrastructure.com](http://www.saishaktiinfrastructure.com)

### PROMOTERS COMPLETED PROJECTS



To own a home is everyone's dream. SVAS Infra along with its group companies has been fulfilling these dreams of many people from past 10 years. So far around 300 families have been residing happily in the homes built by SVAS Infra. We want to touch lives of every individual in one or the other way through our endeavors. As our caption states we have always followed the principle of "PLAN, COMMIT, DELIVER".

[www.svasgroup.com](http://www.svasgroup.com)

# Location Plan

not to scale

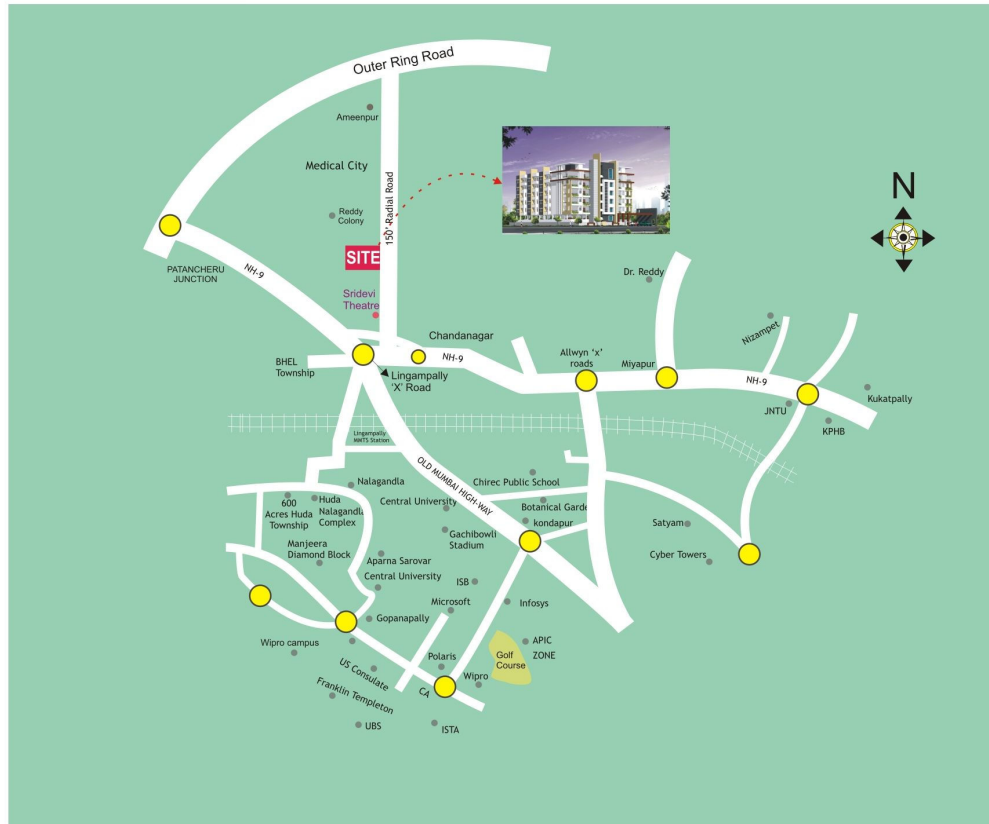

## S.S PROJECTS

Sony Business Complex, 2nd Floor,  
Office # 39 & 40, Prashanth Nagar,  
Kukatpally, Hyderabad - 500 072  
Ph: +91 40 2307 2277, 8897088000  
email: ssprojects@yahoo.com.

### Consultants

  
CHARAN ASSOCIATES  
Kukatpally Hyderabad - 72.  
Ph. No. 23065153