

project by :

**SAISHAKTI
INFRASTRUCTURE**
The Quality Builders & Developers



**SAISHAKTI
INFRASTRUCTURE**
The Quality Builders & Developers



SAISHAKTI INFRASTRUCTURE PVT. LTD.
AN ISO 9001-2008 AND CRISIL CERTIFIED COMPANY

Flat No. 104, Sai Sree Apartments,
Camelot Layout, Botanical Garden Road,
Kondapur, Hyderabad - 500084
CIN: U45200TG2006PTC048944
Mob: +91-88974 99399, Tel: 040-40250259
Email: sales@ssinfra.net
www.saishaktiinfrastructure.com



Varma Consultancy Services

Note: This brochure is only a conceptual presentation of the project and not a legal offering. The promoters reserve the right to make changes in the elevation, plan and specifications as deemed fit

saishakti siddharth

Lake retreat



Sparkle frame 8019242496

saishakti siddharth

Lake retreat

Where the green grass, wild flowers, tender breeze of blue lake, opaline sky and you live together. start your day with the refreshing cool breeze, take a stroll on the finely chopped grass. Smell nature's fragrance and be the closest to nature which is located at Camelot Layout, kondapur.

Saishakti siddharth Lake Retreat will help you get away from hustle and bustle of everyday life. Helps you relax, strip down the stress and enjoy the beautiful lake view with nature.

Location Map

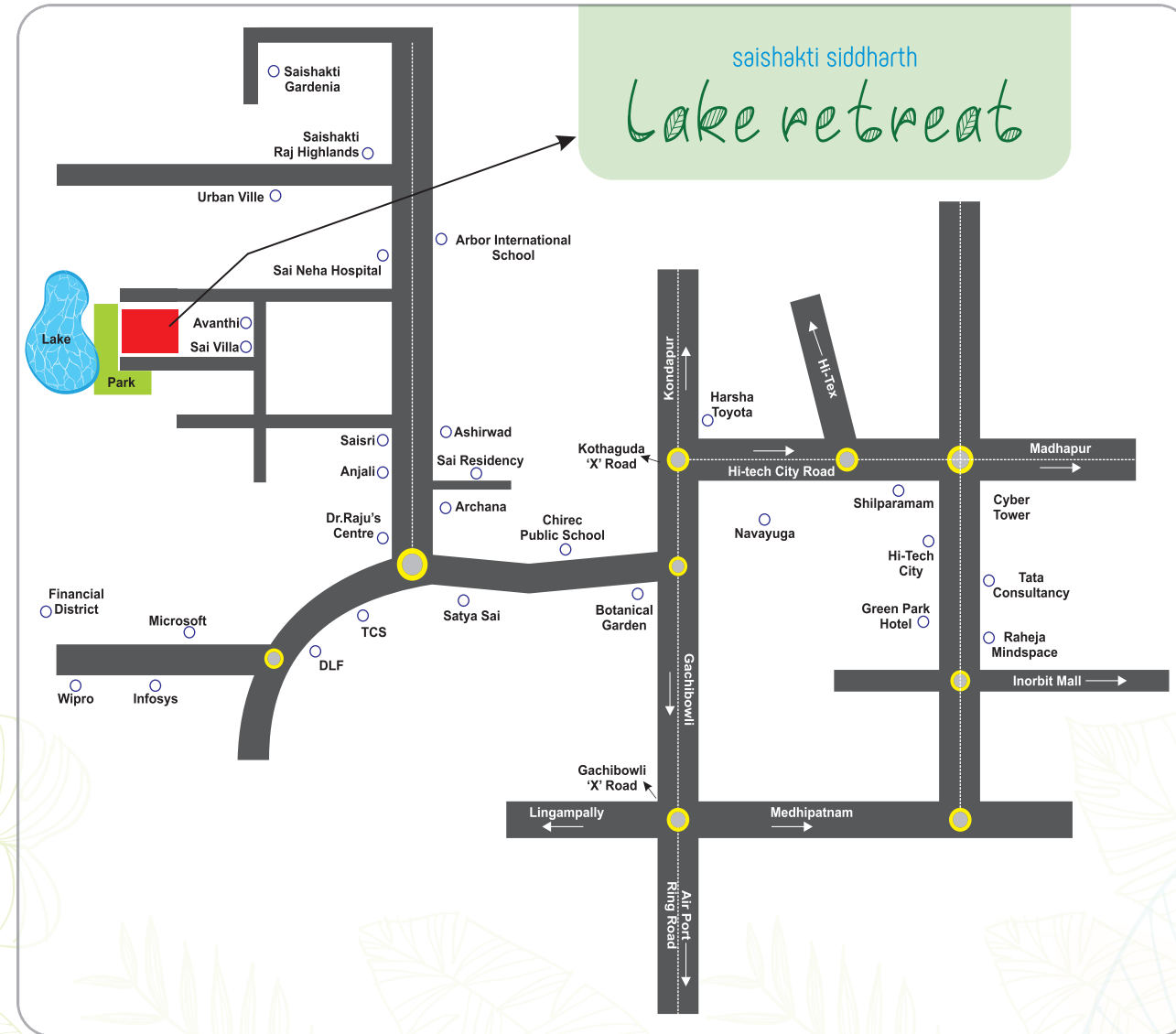

Previous Projects



On going Projects



Amenities

- Landscaping
- Intercom: All Flats and watchman
- DG set backup for 3 lights and 3 fans in each flat.
- Car Parking
- 5 Passenger Lift



saishakti siddharth Lake retreat

Saishakthi, the pioneers of Camelot Layout earned a resounding reputation for developing the area and building the finest homes with their dedication to quality, innovative concepts and futurist vision. Saishakti siddharth Lake Retreat, set amidst the beauty of lake and park, where all the development is happening. This is an opportunity to own a prime residential apartment before prices sky rocket.

Specifications

FOUNDATION:

- Earthquake resistant (as per Zone II specifications) RCC framed structure.

WALLS:

- Light weight brickwork in cement Mortar with 9" external walls and 4.5" internal walls.

PLASTERING:

- Two coats, smooth finish.

WINDOWS:

- UPVC Windows with MS painted grills with Mosquito mesh.

DOORS:

- Frames: All door frames with teak.
- Main Door: Panelled teak veneer shutter with standard fittings and locks with both sides polish.
- Internal Doors: Laminate Doors from Ecor Doors.

FLOORING:

- Double charged Vitrified Tiles in all the rooms, hall and kitchen
- Balconies with exterior tiles.
- Anti skid Ceramic tile flooring for toilets and wash areas.

KITCHEN:

- High Polished granite top cooking platform with stainless steel sink.
- Provision for exhaust fan and chimney.
- Glazed ceramic tile dado up to 2'0" height, above kitchen platform.



www.saishaktiinfratructure.com

PAINTING:

- **Interiors:** Smooth finish with atek luppam with 2 coats of Acrylic emulsion paint.
- **Exterior:** As per architects specifications.

COMMUNICATION SYSTEMS:

- Telephone points and TV points in living room.
- Internet provision in master bedroom Cat6 cables.

TOILETS:

- All C.P fittings are chrome plated for all bathrooms.
- Designer tiles in toilets with accents for dado upto lintel level.
- EWC with health faucet for all bathrooms of Hindware, CERA or equalant.

ELECTRICAL:

- Concealed internal wiring with insulated copper wires for all points.
- Best quality modular type switches and sockets of legrand.
- Adequate number of light/fan points in every room considering interior layouts.
- Earthing as per standards.
- Adequate power connection.

Typical Floor Plan

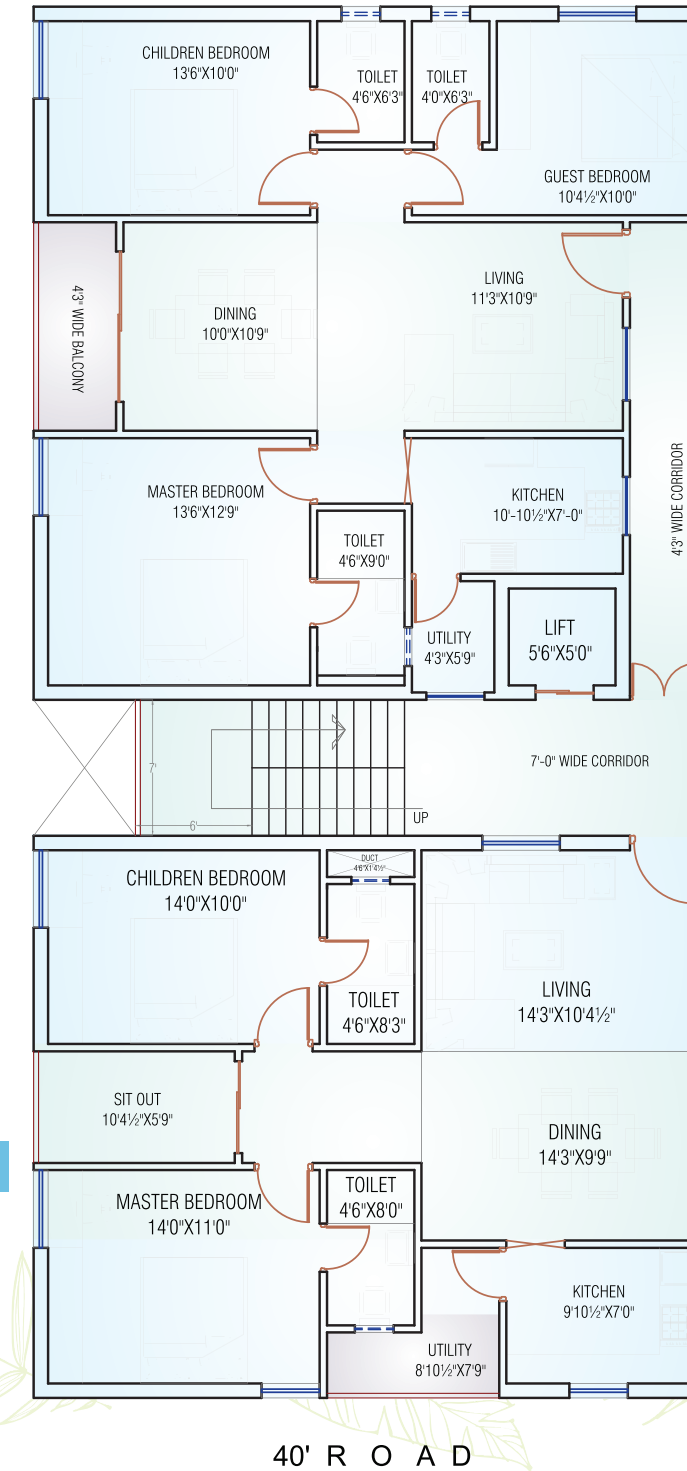

| Unit | Facing | Sq. Ft |
|-------|--------|--------|
| 2 BHK | North | 1269 |
| 3 BHK | East | 1530 |

